

Abbreviation of corporation name

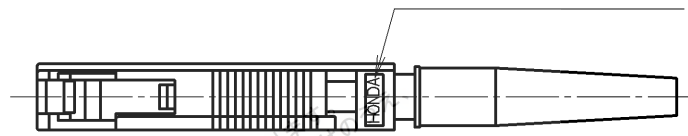

Note 1) This drawing shows assembled product.
However, All parts are shipped unassembled.

Note 2) A cap is assembled to this part.

Table 1)

Part No.	Boot color
LGC-PH603L	Mauve
LGC-PH603B	Blue

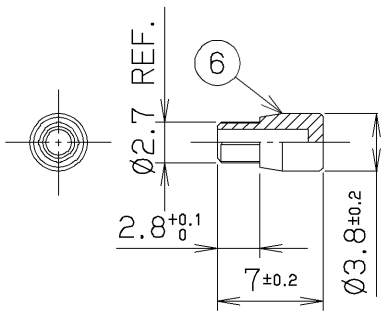

RoHS COMPLIANT

No.	PART NAME	MATERIAL	QTY	FINISH	NOTE
6	Cap	Polyester elastomer	1	————	Color : Blue See Note2
5	Boot	Rubber	1	————	Color:See Table 1
4	Stop-ring	Brass	1	Nickel Plated	————
3	Spring	Piano wire	1	Nickel Plated	————
2	Plug-frame	PBT Resin	1	————	Color:White
1	Coupling Device	PBT Resin	1	————	Color:Brown

LTR.	DATE	BY	REV.	DESCRIPT	No.	PART NAME	MATERIAL	QTY	FINISH	NOTE
△3										
△2										
△1										

DATE	SCALE	UNIT	3RD. A. P	HONDA TSUSHIN KOGYO CO., LTD.						
APP. DATE&REV.	DR.	DE.	CHK.	CHK.	APP.	NAME	MU-PH Type Connector Plug Housing (For Ø0.9 Cord)			
MAY.02.2007	2/1	mm (INCH)								
	N. GOTO	—	T. KOISO	Y. OHKUBO	T. EGUCHI	PART NO.	LGC-PH603 () +R	REV.		